

ABERNATHY and ASSOCIATES

Kenneth B. Abernathy Jr.

Wisconsin Registered Land Surveyor S-1594

W4056 BRAY RD.
ELKHORN, WI. 53121
PHONE: (262) 723-4260 (OFFICE)
(262) 723-7209 (FAX)
Email: abernathy@elknet.net

PLAT OF SURVEY

WEST 1/4 CORNER
SEC. 19-3-17

C.S.M. 1726

A PARCEL OF LAND LOCATED IN THE
SOUTHWEST 1/4 OF SECTION 19, TOWN
3 NORTH, RANGE 17 EAST, CITY OF
ELKHORN, WALWORTH COUNTY,
WISCONSIN.

ORDERED BY:
SWATEK ENTERPRISES, INC.
1050 CAREY ST.
LAKE GENEVA, WI. 53147

REFERENCE LEGAL DESCRIPTION

AS FOUND IN TITLE COMMITMENT NUMBER 404202 BY
CHICAGO TITLE INSURANCE COMPANY

A piece or parcel of real estate situated in the
West 1/2 of the Southwest 1/4 of Section 19,
Township 3 North, Range 17 East, City of Elkhorn,
Walworth County, Wisconsin and described as
beginning at a point on the west line line of said
Section 19 that is 1,042.60 feet North of the
Southwest corner thereof; thence East parallel
with the South line of Section 295.16 feet to a
stake; thence North parallel with the West line of
said Section 19, 295.16 feet to a stake; thence
West parallel with the South line of said Section,
295.16 feet to a point in the West line of said
section, being the center of the highway; thence
South in said centerline 295.16 feet to the place
of beginning. Stakes are set at point 9.1 feet
East of the West line of said real estate so
conveyed at the edge of the pavement on both the
North and South lines thereof. Excepting therefrom
that part of the above described premises awarded
to the State Highway Commission for highway
purposes as contained in Volume 625 of Deeds on
page 420 as Document No. 574975.

SOUTHWEST CORNER
SEC. 19-3-17

UTILITY PEDESTAL

(WEST 295.16')
N 87°23'43" E 295.18'
262.18'

EXISTING GRAVEL PARKING LOT

GREEN AREA

YUNE - 37

1.74 acres total

C.S.M. 1726

EXISTING BLACKTOP DRIVEWAY

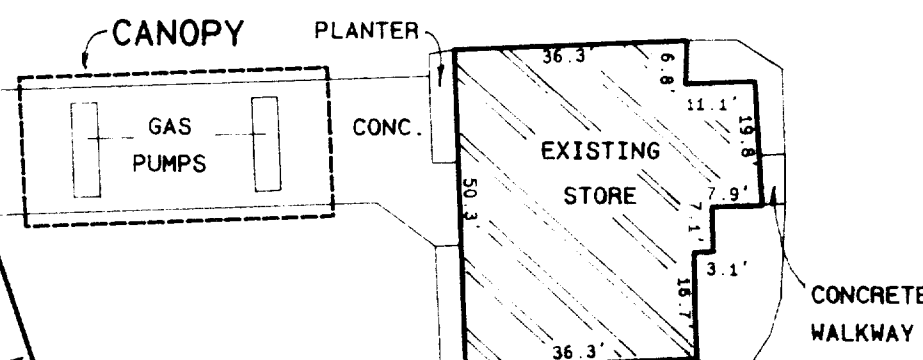

EXISTING BLACKTOP DRIVEWAY

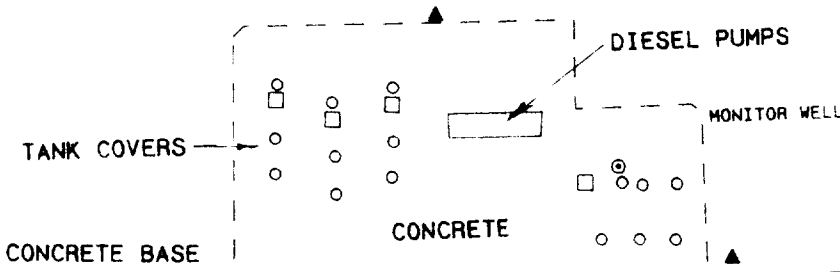

GREEN AREA

TREE AT CORNER

FOUND IRON PIPE
IS S 20°40'26" W
1.16' FROM CORNER

Legend

- FOUND IRON PIPE
- FOUND IRON ROD
- FOUND BRASS CAPPED MONUMENT
- FOUND CONCRETE MONUMENT
- ✦ CHISEL CUT IN CONCRETE
- SET IRON ROD, 24" LONG, WEIGHING
1.5 LBS. LINEAL FT., 3/4" DIA.
- SET IRON ROD, 30" LONG, WEIGHING
4.5 LBS. LINEAL FT., 1-11/16" DIA.
- (XX) RECORDED AS DIMENSION
- EXISTING FENCE

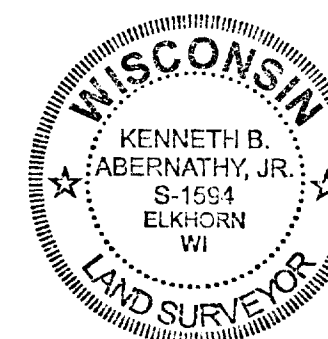

SCALE: 1" = 30 FEET

I hereby certify that the above described property has been surveyed
by me or under my direction and that the above map is a true
representation thereof and shows the size and location of the property
its exterior boundaries, the location of all visible structures and
dimensions of all principal buildings thereon, boundary fences, apparent
easements, roadways and visible encroachments, if any.
This survey is made for the use of the present owners of the property
and also those who purchase, mortgage, or guarantee the title thereto
within one year from date hereof.

Kenneth B. Abernathy, Jr.
KENNETH B. ABERNATHY, JR.
WISCONSIN REGISTERED LAND SURVEYOR,
S-1594

Date: SEPT. 16, 2003 Job No. 98.704

SCALE 1" = 30 FEET

HIGHWAY REFERENCE LINE OF PROJECT T 04-1(22) & VOL.
625 OF DEEDS, P. 420, DOC.# 574975

WIS. STATE HIGHWAY PLANS DATED
11-24-1964

YUNE -37

004-1716